

2050 - Cultures of living

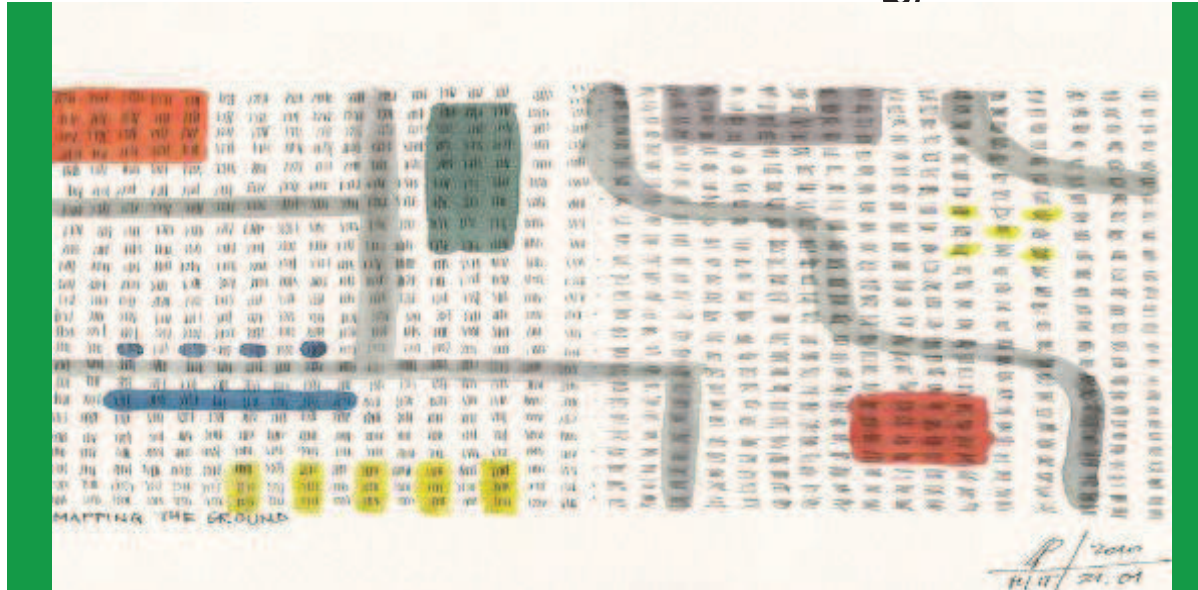

Luciano CRESPI "Interior as exterior"
Davide FASSI "Temporary Urban Solutions" (speaker)
Giovanna PICCINNO "City Spatial Design"

"2050 - cultures of living", Ahmedabad, India

22/02/2010

POLITECNICO DI MILANO - SCHOOL OF DESIGN, ITALY

POLITECNICO DI MILANO



FACOLTÀ DEL DESIGN

THE NEW ROLE OF INTERIOR DESIGN IN RELATION TO SPATIAL DESIGN



PIPILOTTI RIST- CARLOS MARTINEZ

Design disciplines
Bordering disciplines
Exchange of codes
and languages

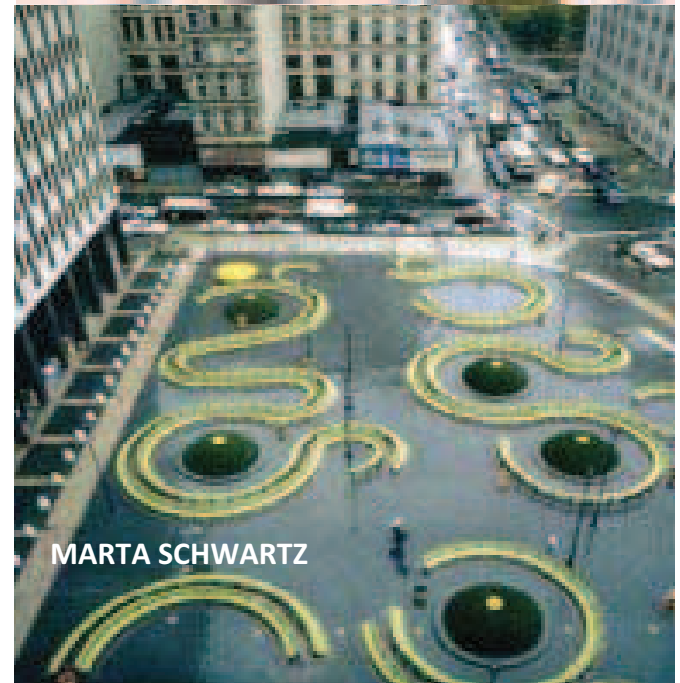

restructuring of the
internal urban spaces
metamorphosis of the
external urban spaces,
in and out network
exchange
Threshold
in-between

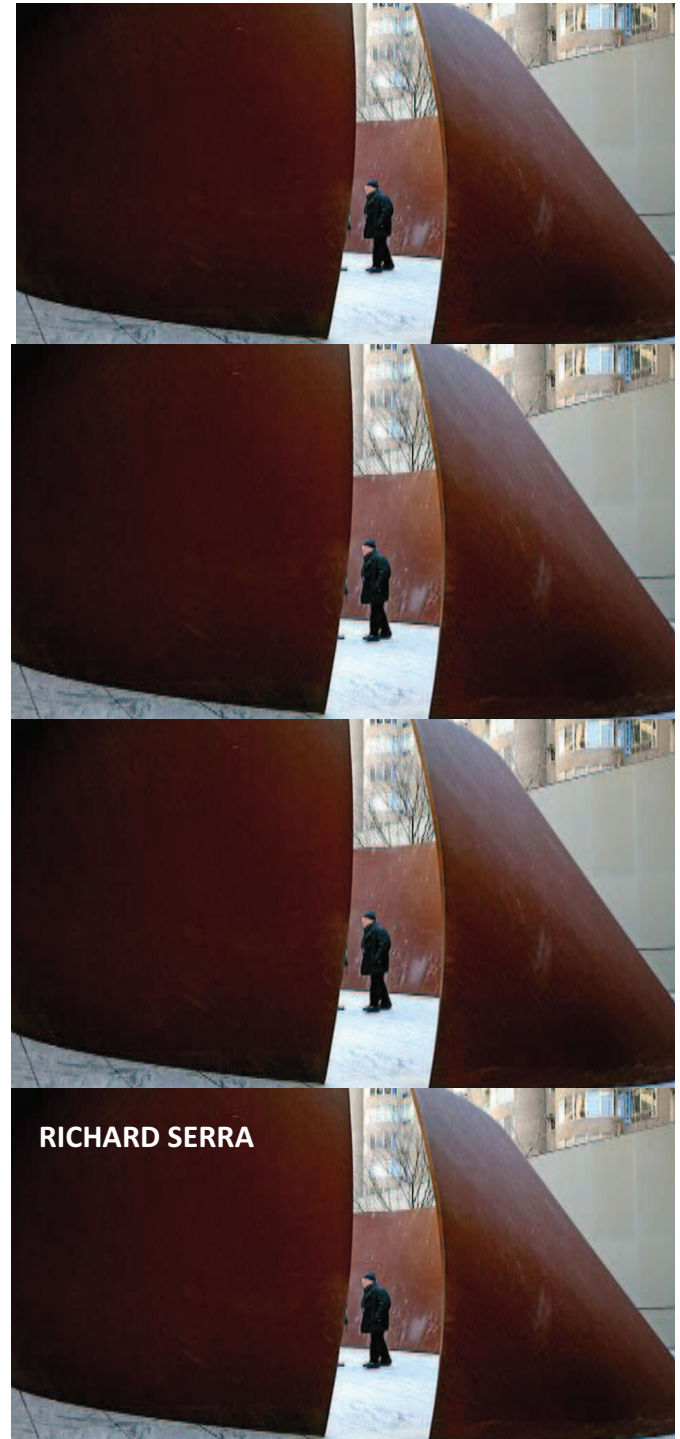

transformations
the *inside* of buildings.
silent invasion
Spontaneous
modern city dwellers



places that are
progressively less
specialised (internal and
external).

spaces that require
great flexibility.

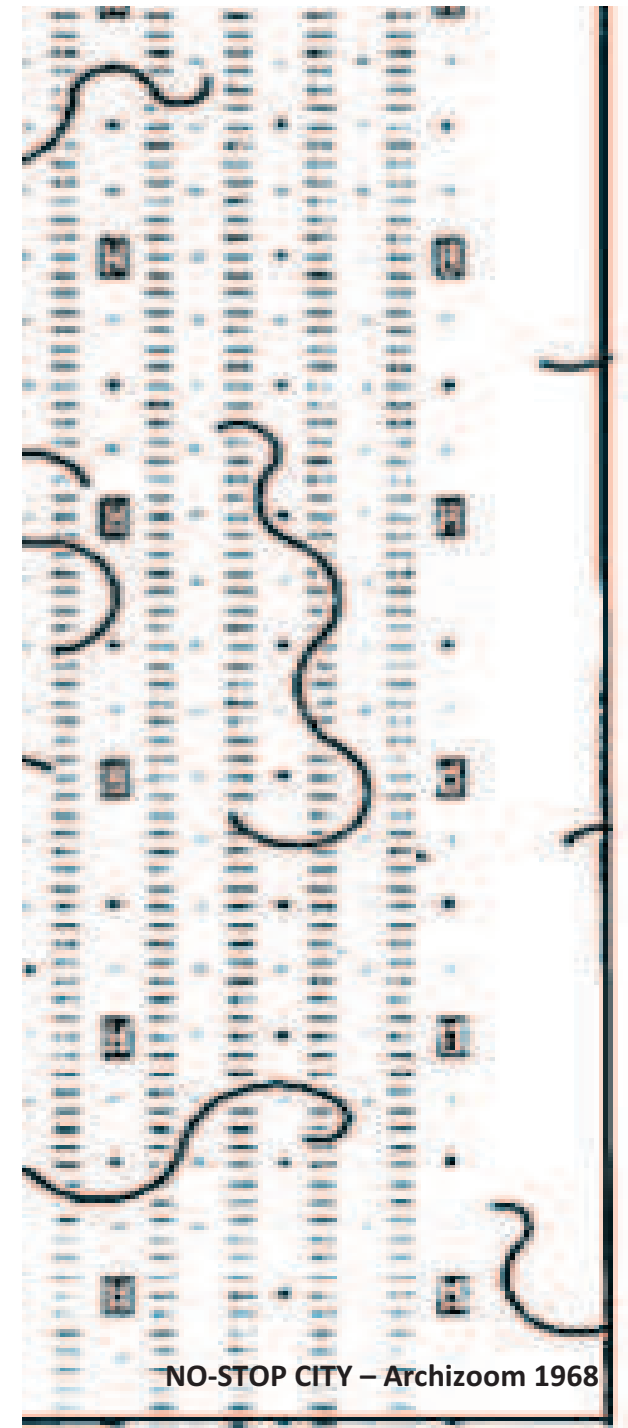

NO-STOP CITY – Archizoom 1968

re-functionalised spaces
permeable and adaptable
privacy personal
spaces

osmotic
(relation in-out/ internal-external)



Environmental performances

Different typological ways of inhabiting spaces

adaptability, flexibility,
reversibility.

quality of the spaces

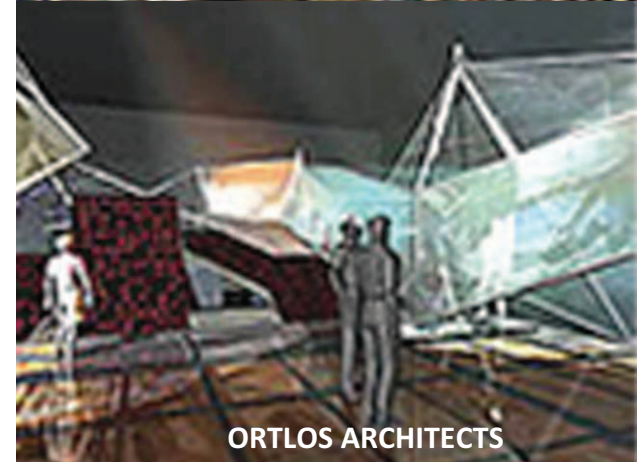
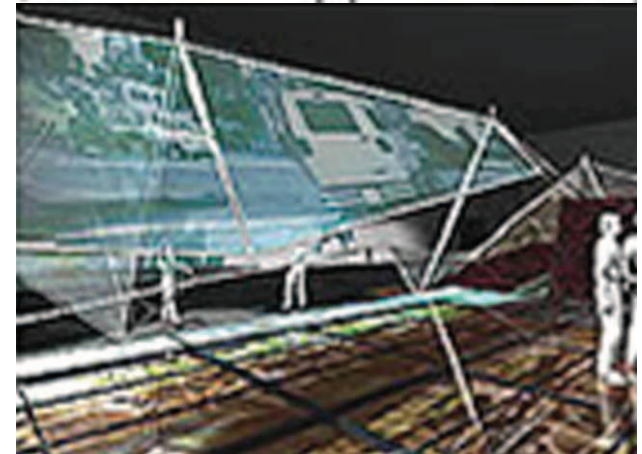
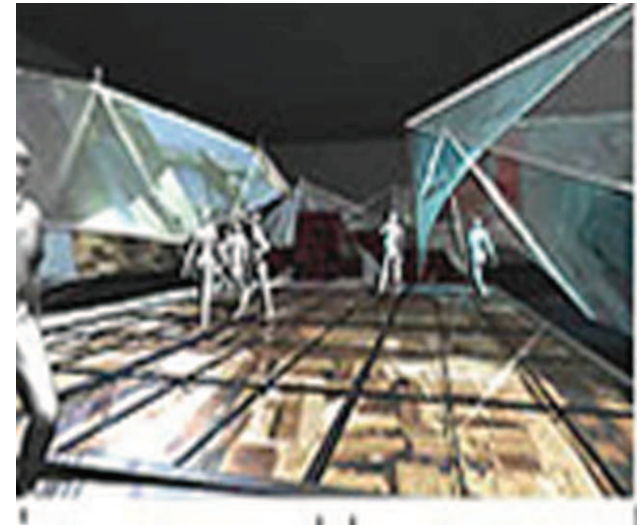

ORTLOS ARCHITECTS

Linked to Product Design

**Answering to new
needs/behaviours**

**Study production techniques which
are sustainable and innovative**

**Verify the possibility of production
according to variable series**

**Investigate the value of
materials**

Integrate new technologies

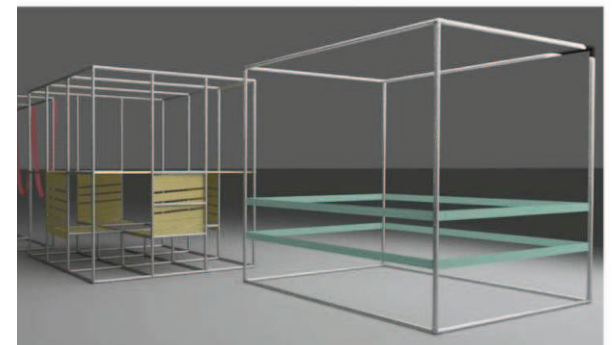
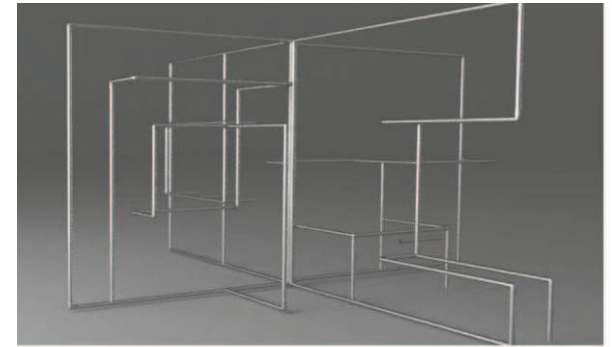

primary design
perceptive/qualitative value

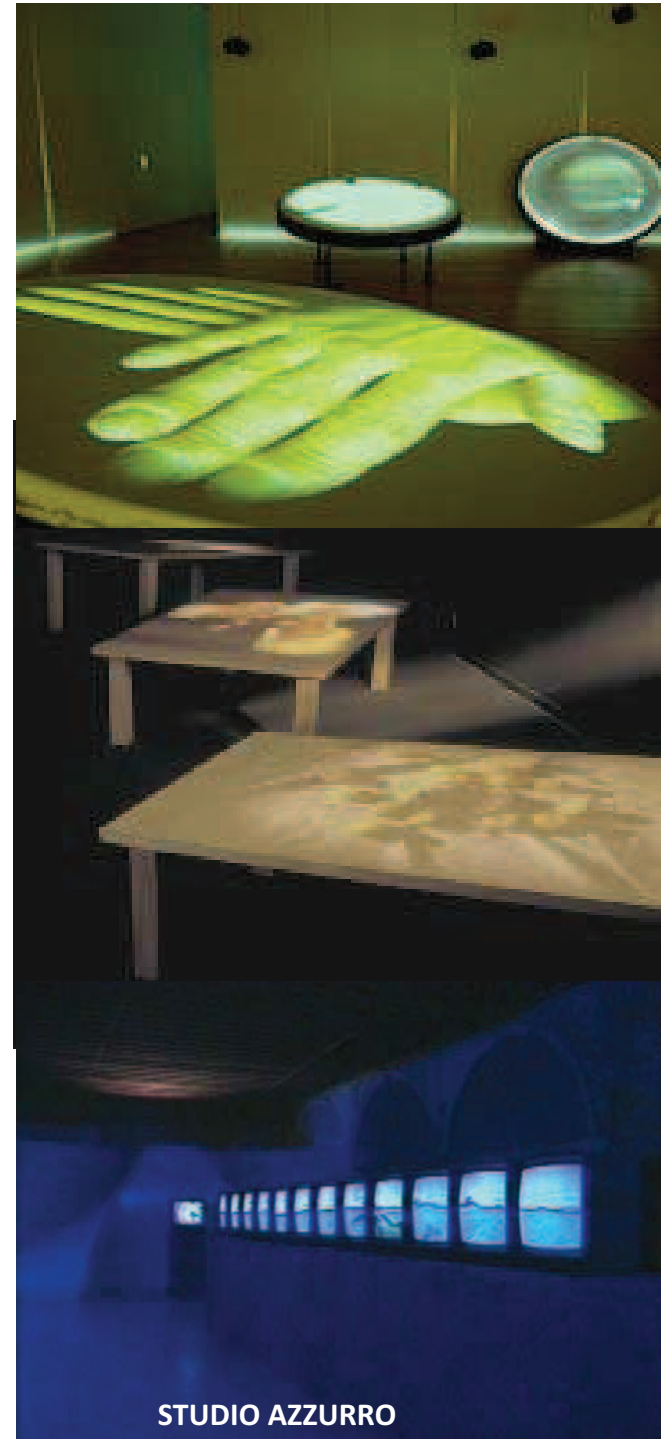

reconfiguration
metamorphosis
urban space
fluxes
activities
relation in-out

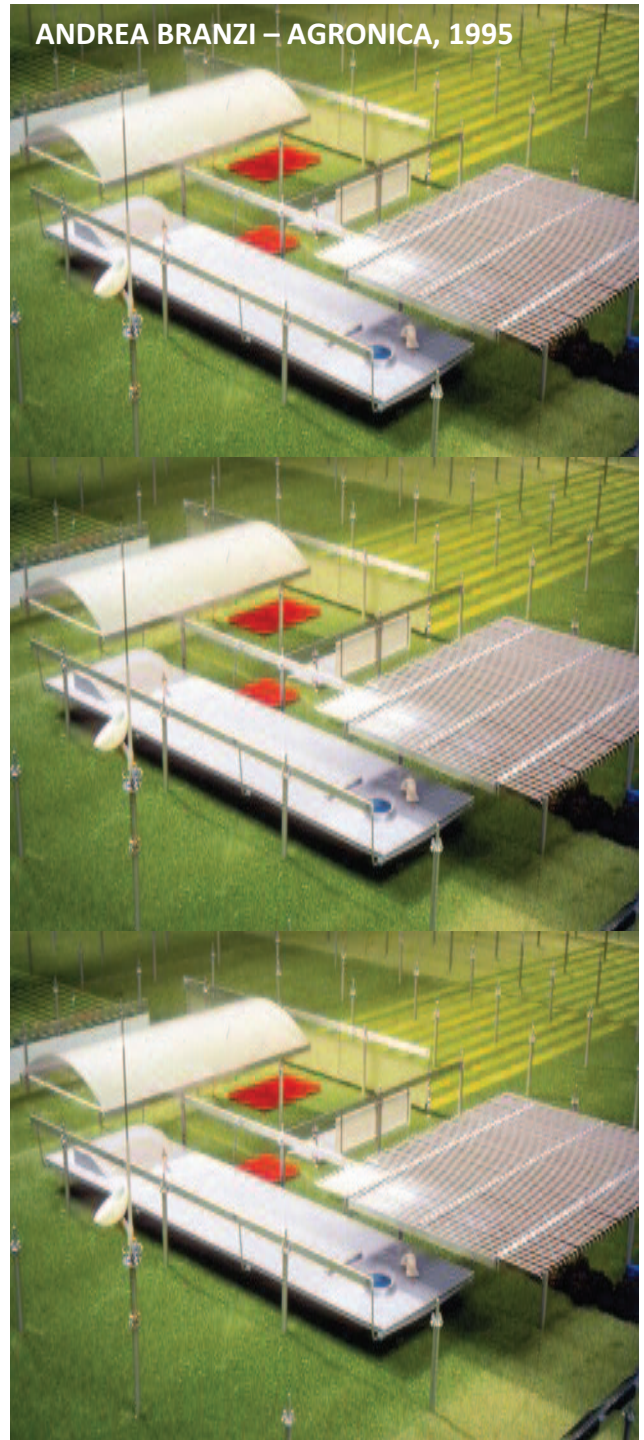

new landscapes
urban internal-external
invisible information
network
quality of living

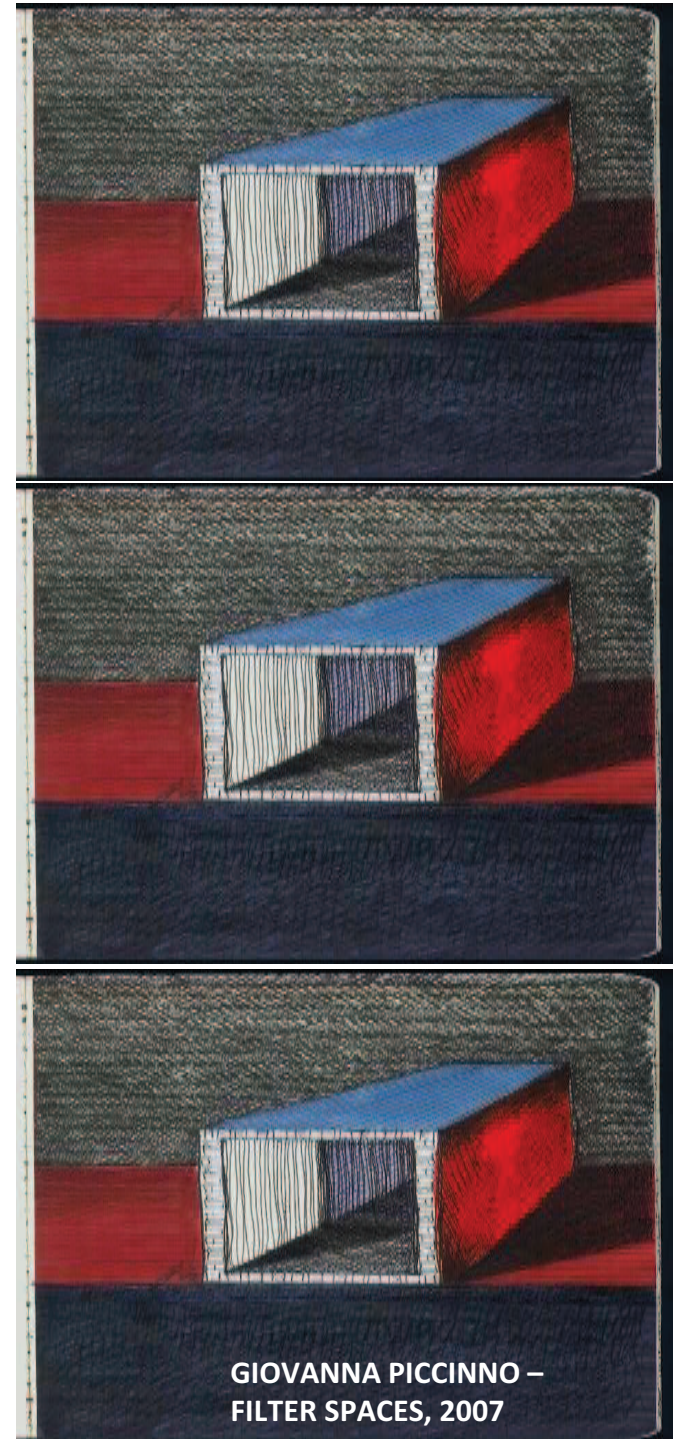

**Temporary design
post industrial era
continuous transformation**

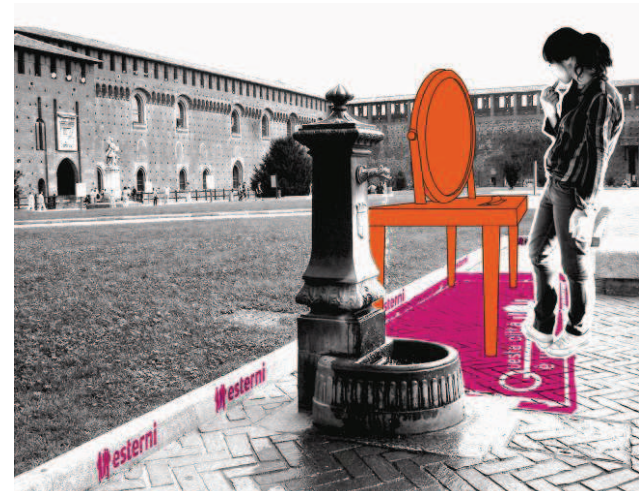

How industrial production affected
Architecture?

Components and
dismantle vs traditional
construction technique

Temporary as a
result of the
development of
technology?

What the consequences
on design?

"ETR 300 SETTEBELLO", Piazza Loreto, Milano, 1959, Giulio Minoletti



“Palazzo di Fuoco”, Piazza Loreto, Milano, 1959, Giulio Minoletti



Bathroom, 1950, Giulio Minoletti

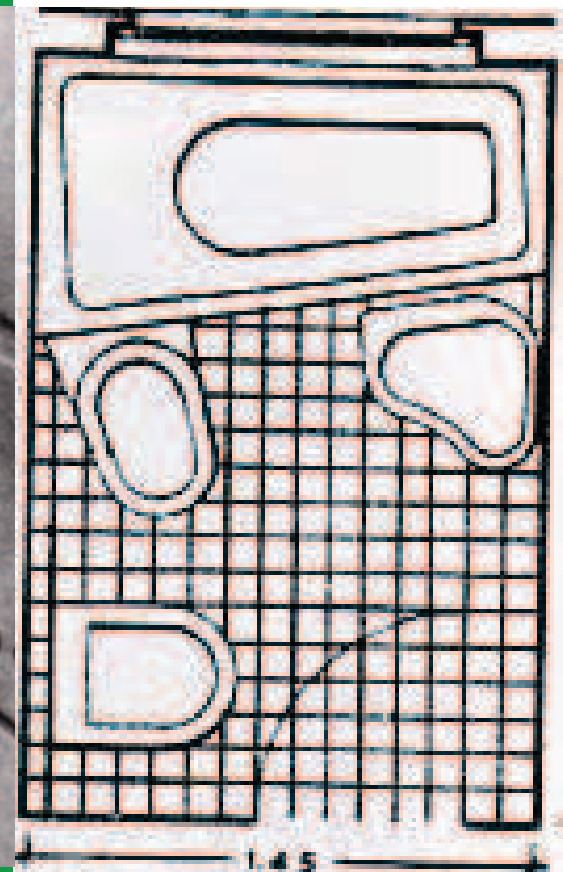

EVENTS



“Stupido Hotel Tour 2001”, GiòForma

EVENTS

THAT'S DESIGN, Salone del Mobile 2008, Milan Design Week, Ex-Ansaldo Zona Tortona

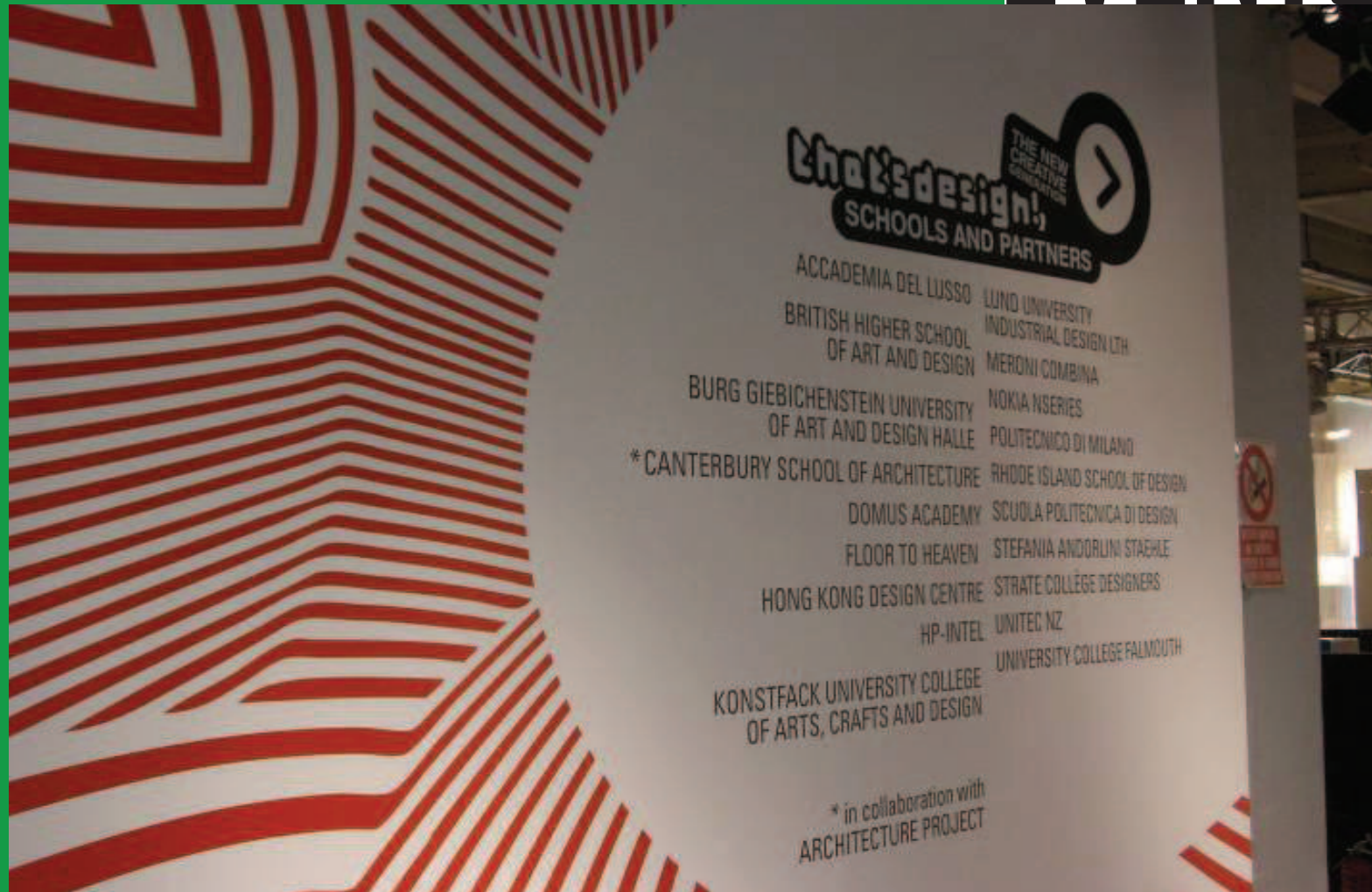

EVENTS

THAT'S DESIGN, Salone del Mobile 2008, Milan Design Week, Ex-Ansaldo Zona Tortona



EVENTS



THAT'S DESIGN, Salone del Mobile 2008, Milan Design Week, Ex-Ansaldo Zona Tortona

EVENTS



Storefront for Art And Architecture, Steven Holl, 1992, New York

EVENTS



Storefront for Art And Architecture, Steven Holl, 1992, New York

EVENTS



Storefront for Art And Architecture, Steven Holl, 1992, New York

"IL SALONE E' FUORI", Milan Design Week, ESTERNI

EVENTS

**ilSalone
e FUORI**
THE OPPOSITE EVENT

una produzione **esterni**

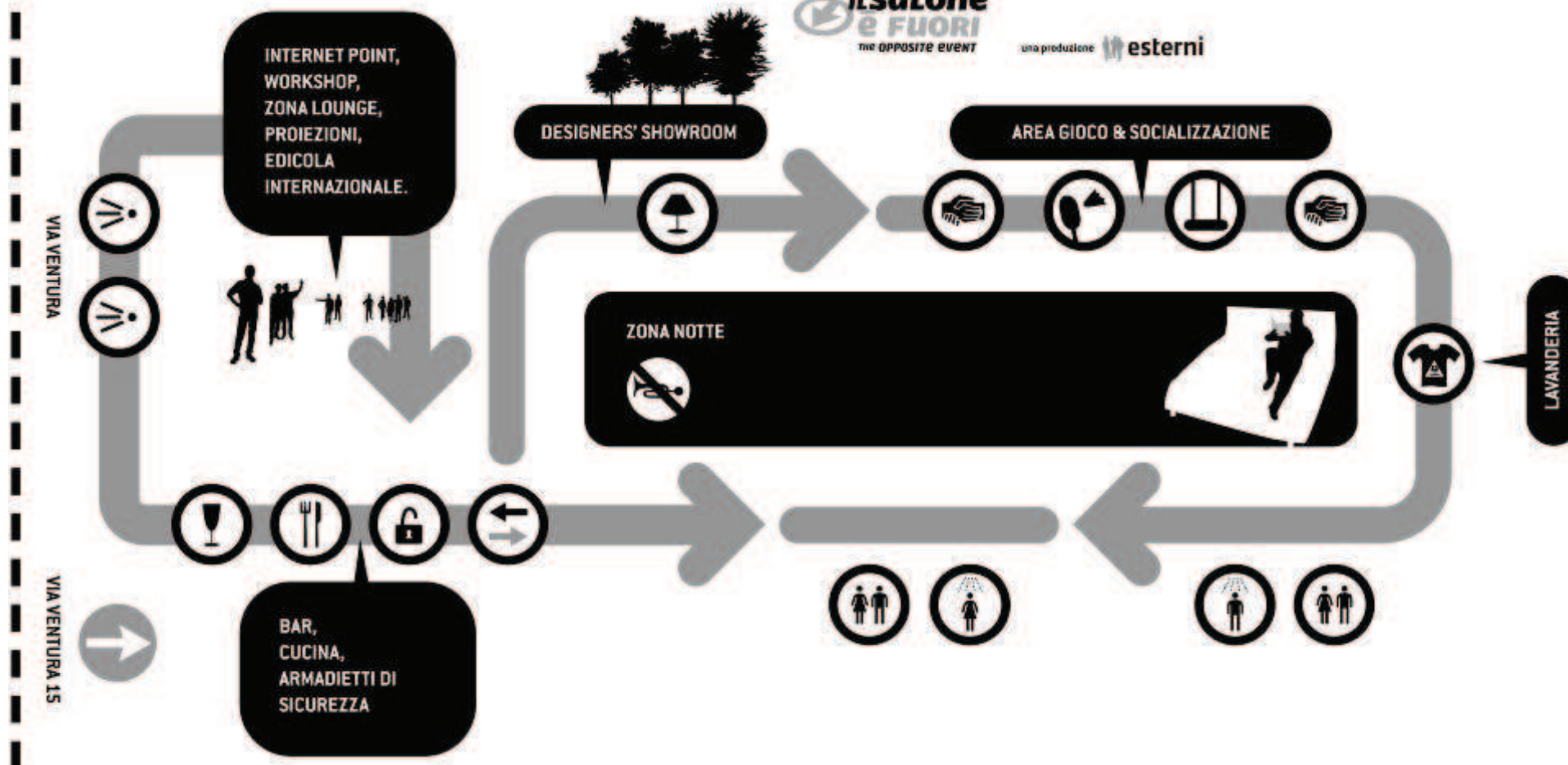

EMERGENCY



“Re-Cover”, project for post-distaster shelter, Politecnico di Torino

EMERGENCY

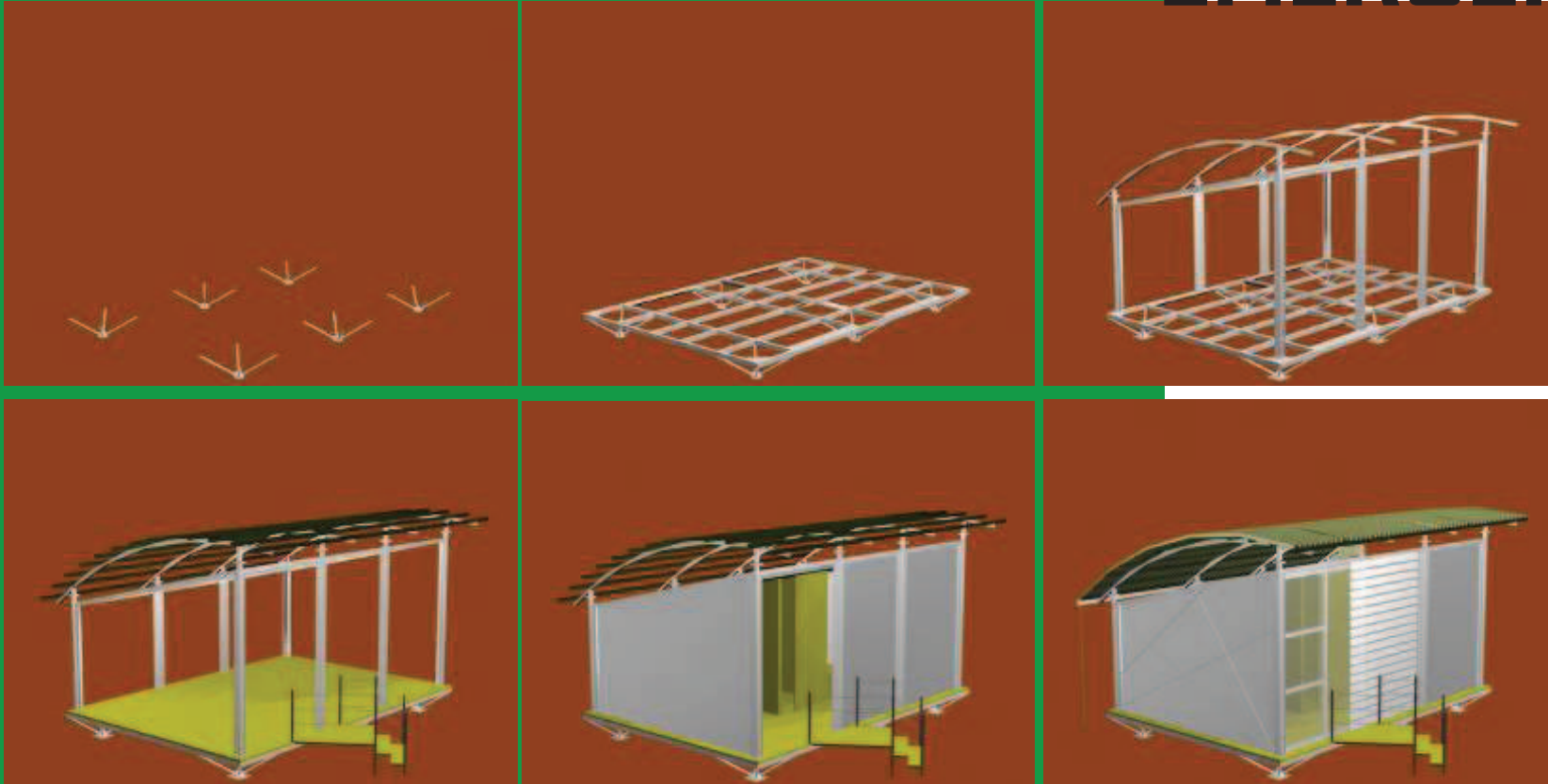

“Re-Cover”, project for post-distaster shelter, Politecnico di Torino

EMERGENCY

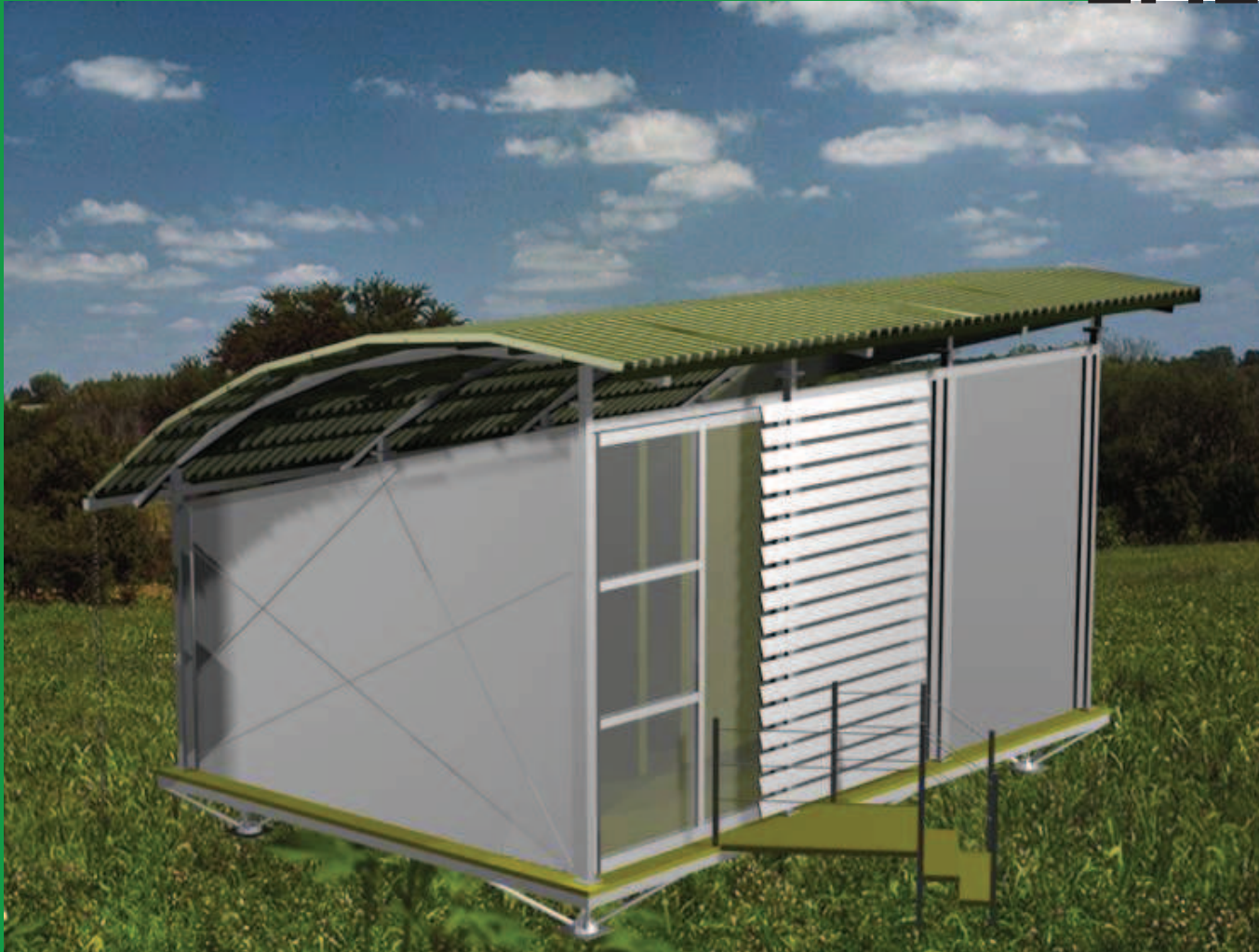

“Re-Cover”, project for post-distaster shelter, Politecnico di Torino

RETAIL

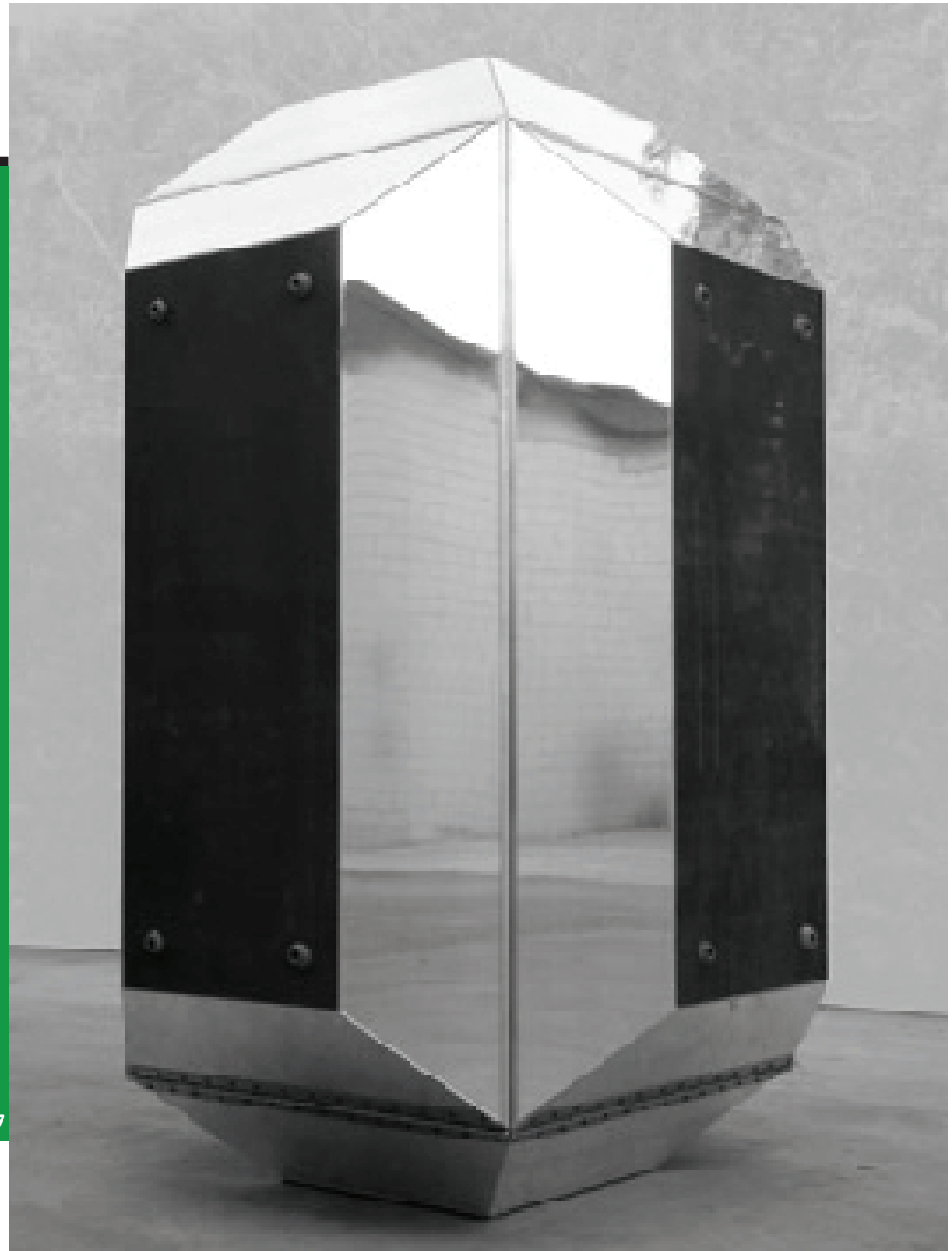

MOvin'Store, ITALIA INDEPENDENT, 2007

RETAIL

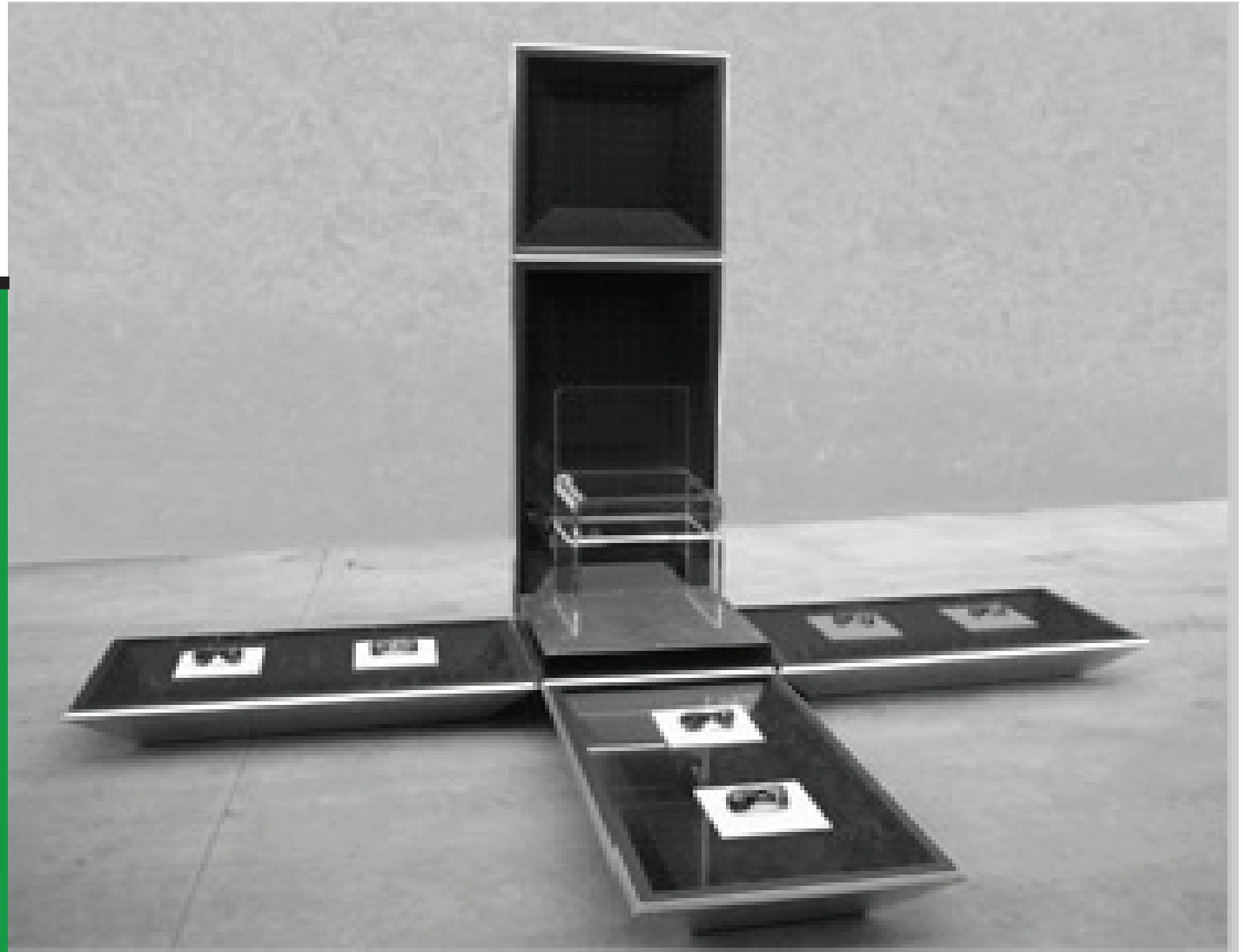

MOvin'Store, ITALIA INDEPENDENT, 2007

RETAIL

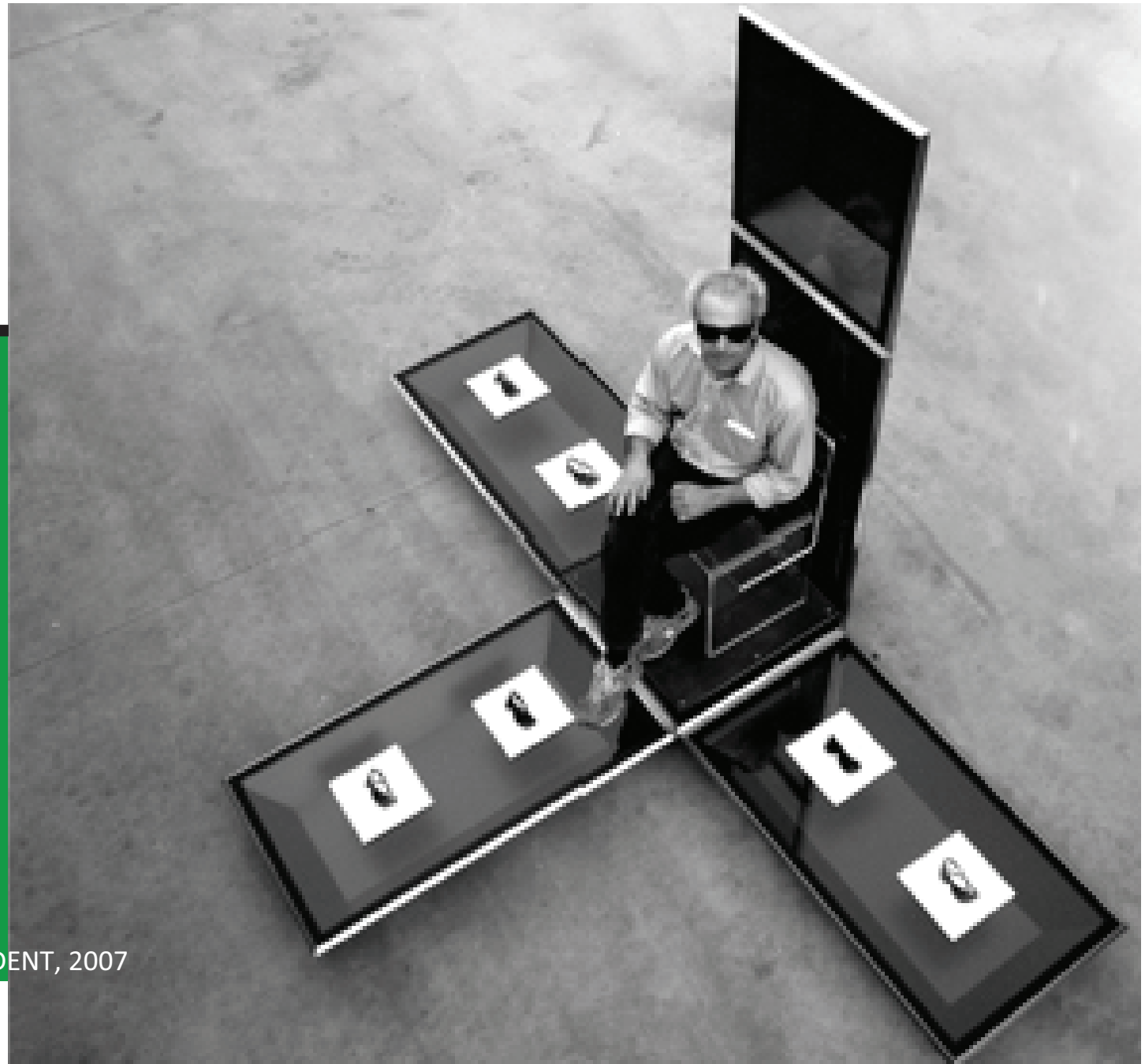

MOvin'Store, ITALIA INDEPENDENT, 2007

RETAIL



MOvin'Store, ITALIA INDEPENDENT, 2007

RETAIL



STREET FOOD MOBILE, Milan Design Week, 2008



STREET FOOD MOBILE, Milan Design Week, 2008

HOSPITALITY

The way we travel has changed, we live and work **IN MOTION**, and this new form of **NOMADISM** or **HUMAN TRANSHUMANCE** introduced mobility as permanent condition.

This widespread and increasingly has therefore raised the question of being able to quickly **ADAPT THE AREA** to the needs of intermittenly flow.

Urban Design Camping stimulates
responses to temporary, light,
REVERSIBLE needs. A device of **RE-**
APPROPRIATION of urban land that is
often perceived as “shared by
everybody but no owned by anybody”

**01_
_CONSTRUCTION TYPE**

**02_
_MATERIALS&TECHNOLOGY**

**03_
_CONNECTION WITH GROUND**

01 CONSTRUCTION TYPE

01.1 ■ Collapsible
(folding structures)

01.2 ■ SPACESHIP
(box-ship)

01.1.1_FLEXIBLE _____ es. new Decathlon tents

01.1.2 _____ from the roulottes' telescopic arms of Zanuso, to the portable
PANTOGRAPH garages of last generation

01.1.3 _____ "container" that opens, extends and closes on itself mainly
COMPACTING through tilting or sliding mechanisms, to a compact solid

01.2.1_CONTAINER _____ all pre-packaged container developments

01.2.2_CAPSULE _____ the spacecraft

01.2.3_X-TREME _____ structures for extreme situations (ex. housing modules for the
SOLUTIONS Poles); "tightness" concept

01.3 ■ TENT
(tent- sail)

01.4 ■ SELF-ASSEMBLAGE
(set up kit)

01.3.1_FIELD TENT _____ traditional tents (from Bedouin to box-tent and photovoltaic fabric)

01.3.2_SAILING TENT _____ high-tech devices inspired by the nautical world

01.3.3_CIRCUS TENT _____ circus tent that hosts events: eg. neighborhood Laboratory of Renzo Piano

01.4.1_ _____ units infinitely replicable
REPEATING UNITS

01.4.2_ _____ variation on the territory
ACCORDING TO
THE CONTEXT

_____ _ready made
_____ _to equip
_____ _to complete

01.5 ■ SOAP BUBBLE
(blob-collapsible)

01.5.1 INDIVIDUAL ____ eg. diving suit

01.5.2 _____ eg. capsules for installations open to the public
COLLECTIVE

02_MATERIALS&TECHNOLOGY

■ 100% BIODEGRADABLE

Made of
RECOVERY -
REUSED
MATERIALS:
umbrellas,
benches, clothes

Made of
RECYCLED
MATERIALS

Structures built with perishable materials that might generate the "ill moment of hospitality": you can keep it as a gift



eg. experiments that are inspired by the favelas or by the self-designing items

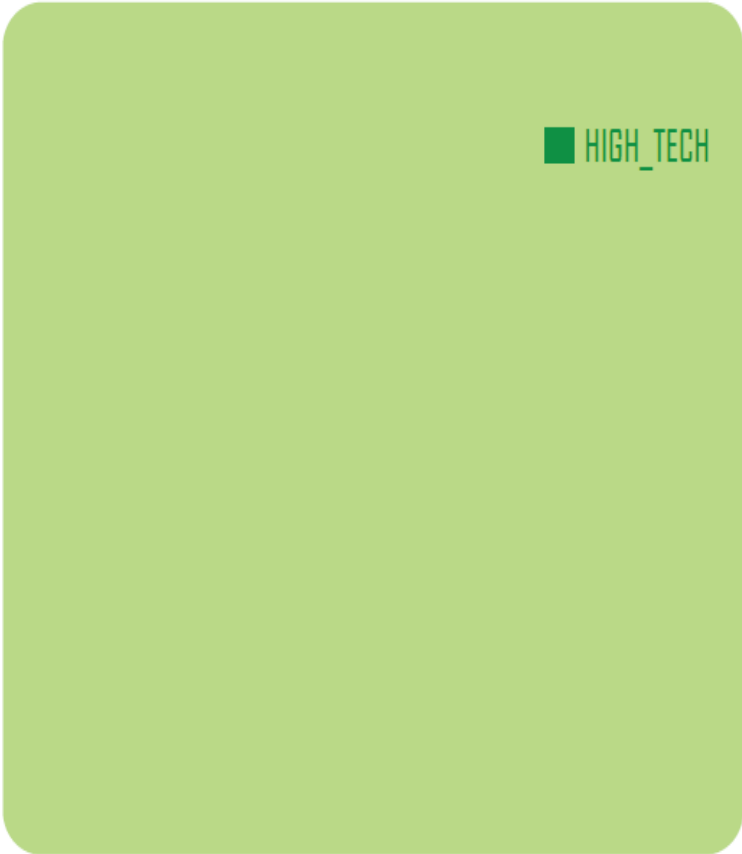

HIGH-TECH
AESTHETICS

HIGH-TECH
TECHNOLOGY



03 CONNECTION WITH THE GROUND

03.1 ■ PILE STRUCTURE
stilts

_containers with adjustable-leveling feet
_Le Corbusier's pilotis

03.2 ■ HANGING

03.3 ■ ON WHEELS

_roulottes
_Shigeru Ban experimentations

03.4 ■ PICKETS

03.5 ■ PLATFORM
platform ready-equipped to provide basic services
(eg. provision of electricity and water)

03.5.1_HORIZONTAL _ motherboard

03.5.2_VERTICAL ____ hive
rigorous or in-progress

03.5.3_VACANT ____ parasite

Collapsible

Title_Cocobello-Mobile Studio
Designer_Peter Haimerl
Location_Monaco

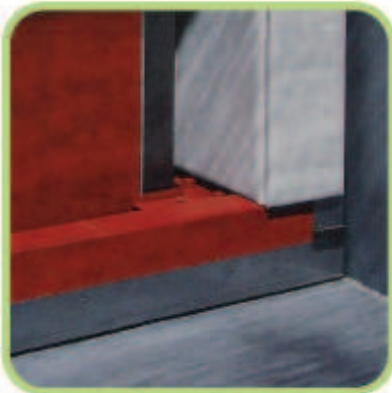

■ Collapsible

Title_A-Z Living Unit
Designer_Andrea Zittel
Date_1994



HANGING

1. Cocoon Emergency Shelter, John Moriarty, 2007
2. Dré wapenar, Tree tents (light tent sculptures), originally designed for the Road Alert Group
3. Ecocoon, Mathier Collos



1.



2.



3.

ON WHEELS

Title Snail Shell System, prototype vehicle

Designer N55

Location and date No fixed address, 2000 & ongoing



PICKETS

A traditional camping tent.

Adaptability to the soil makes the units placement easier. It leads to a high degree of flexibility. It is easy to deliver and low cost



■ Spaceship

Title_Treehouse, "Icon" Treetop Observation Structure
Designer_Gilles Ebersolt
Portable



PLATFORM_vartical

Title Newcastle upon Tyne. The urban campsite
Designer Steve Messam
Location and date Newcastle, Dott's Design Camp, 2007



■ Tent

Title_ Modular architecture

Designer_ Lucy Orta, Studio Orta

Location and date_ No fixed address, since 1996



Tent

Title_Deep purple

Designer_Massimiliano e Doriana Fuksas

Location and date_Milan, Triennale Design, 2008



■ Set up Kit

Title_Kubik

Designer_Modulorbeat

Vacant installation

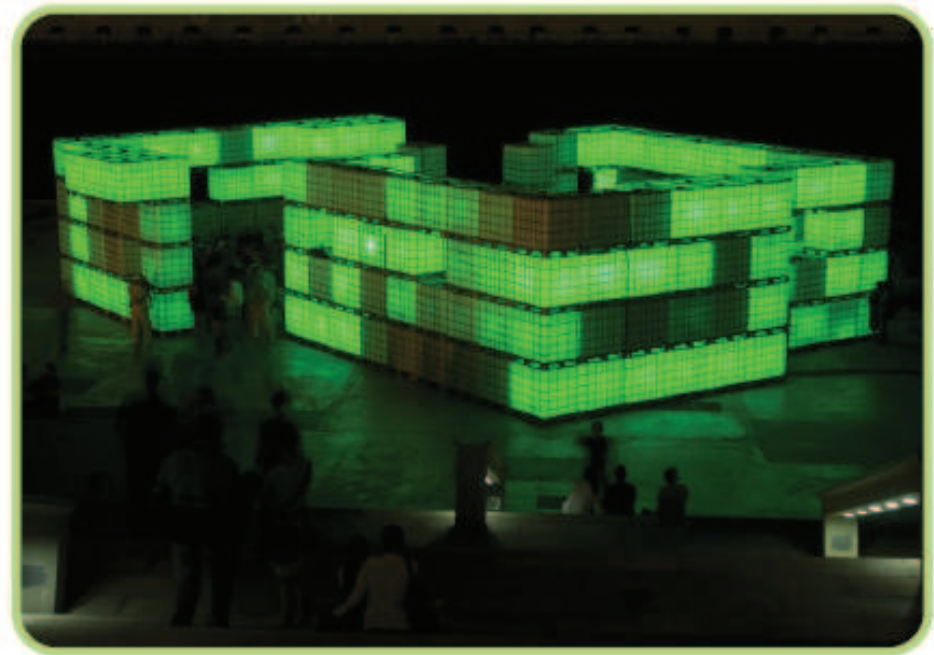

The quality of the environment, the way to be hospitable, to be close to the **"new wanderers"** needs, depend on the quality of the open-space (**outdoor**)

ATOPIC vs NEOTOPIC

NEOTOPIA

"Places designed for new forms of hospitality, able to make different users living together, preserving portions of territory from their fate otherwise "atopic", introducing a high and different idea of sociality, in which the private and collective dimension could reasonably live together" (L.Crespi)

POLITECNICO DI MILANO



FACOLTÀ DEL DESIGN

Luciano CRESPI luciano.crespi@polimi.it

Davide FASSI davide.fassi@polimi.it

Giovanna PICCINNO giovanna.piccinno@polimi.it